

## Stainless Steel T Terminal Back Plate

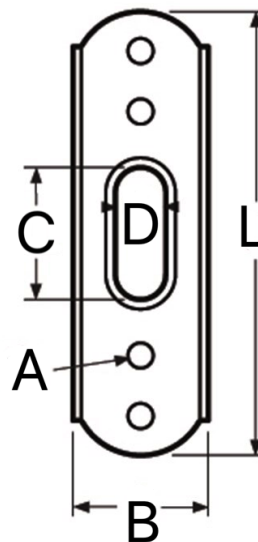

Product Name	A (mm)	B (mm)	L (mm)	D (mm)	C (mm)
3mm Backing Plate	5	15	50	7	14
4mm - 5mm Backing Plate	5	27	88	9.9	27
6mm - 7mm Backing Plate	6.3	39	122	15.6	35

Note - Product sizes are liable to change from time to time, if your dimension requirements are critical, please contact us.