

## Stainless Steel Closed Rigging Screw Body

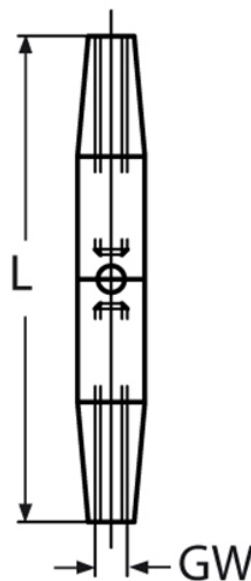

Product Name	L (mm)	GW
M4 Stainless Steel Closed Body	70	M4
M5 Stainless Steel Closed Body	80	M5
M6 Stainless Steel Closed Body	95	M6
M8 Stainless Steel Closed Body	105	M8
M10 Stainless Steel Closed Body	125	M10
M12 Stainless Steel Closed Body	150	M12
M16 Stainless Steel Closed Body	190	M16
M20 Stainless Steel Closed Body	210	M20

Note - Product sizes are liable to change from time to time, if your dimension requirements are critical, please contact us.