

Stainless Steel T Strap Hinges

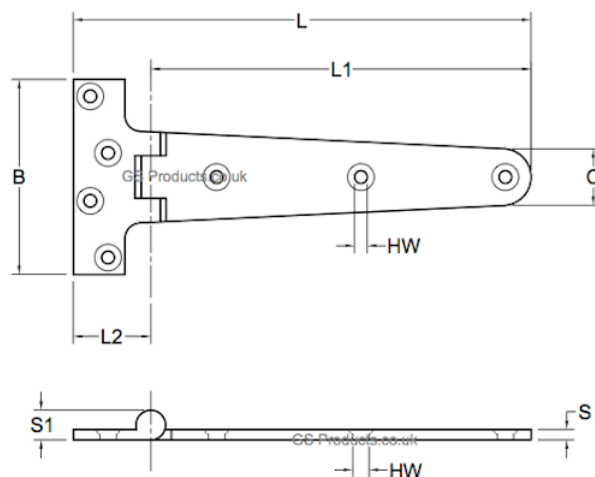

Product Name	B (mm)	L (mm)	C (mm)	S (mm)	L2 (mm)	L1 (mm)	HW (mm)	S1 (mm)
100mm Stainless Steel Tee Hinge	54	100	20	4	35	60	5	9.5
152mm Stainless Steel Tee Hinge	75	152	20	4	35	110	5	9.5
197mm Stainless Steel Tee Hinge	98	197	20	4	50	147	5	9.5

Note - Product sizes are liable to change from time to time, if your dimension requirements are critical, please contact us.